

SNOW TUBE

INTERACTIVE TUBE

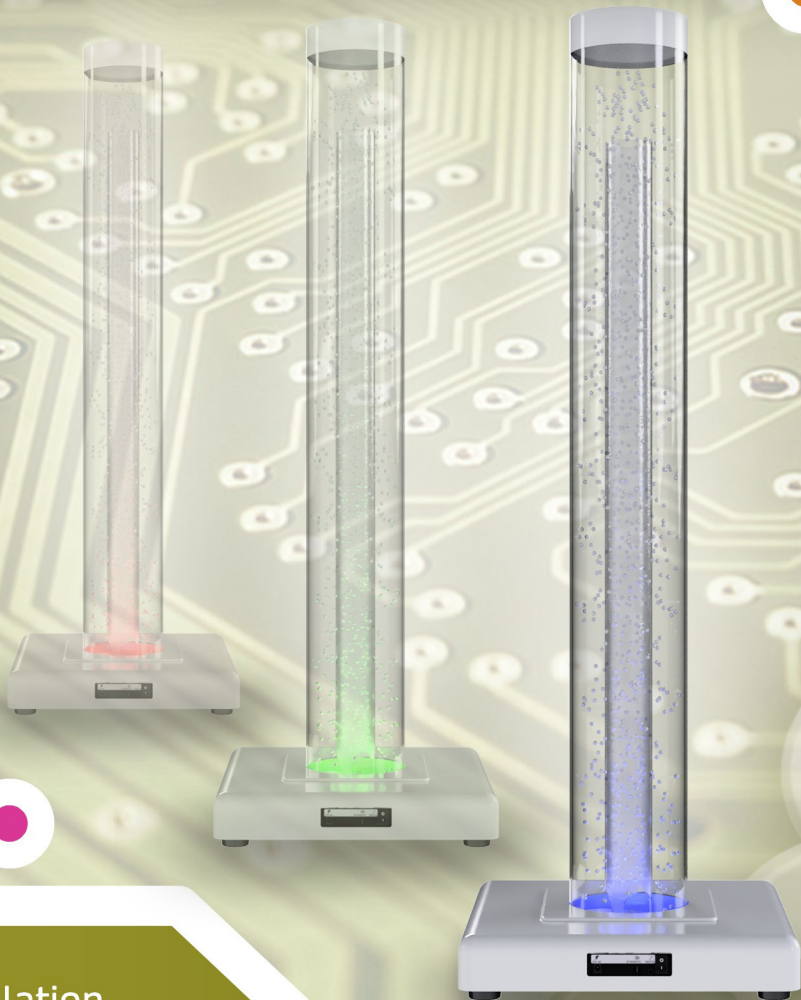

Installation,
Operation &
Care Manual

DIMENSIONS

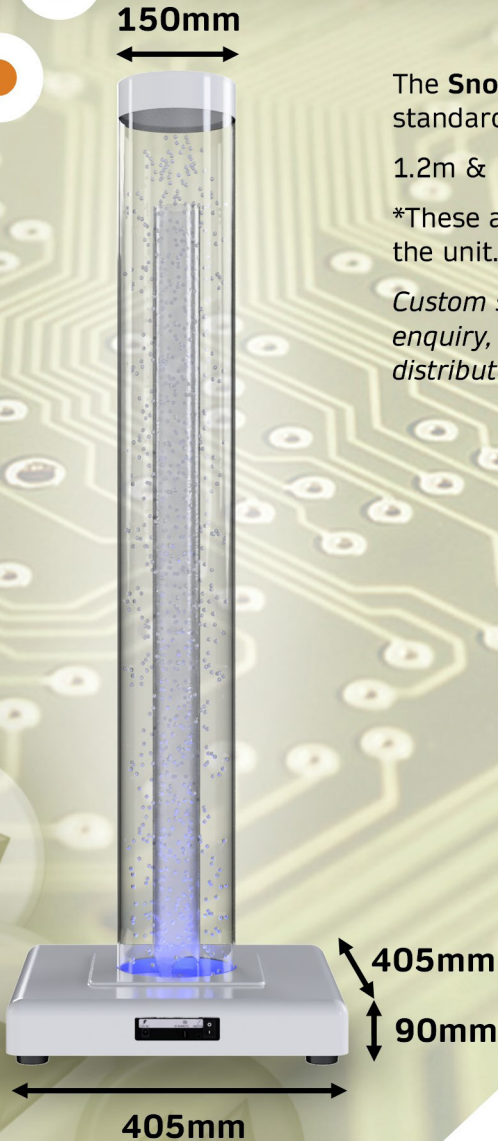

The **Snow Tube** comes in 2 standard sizes:

1.2m & 1.5m

*These are the overall heights of the unit.

Custom sizes are available upon enquiry, please contact your distributor.

SNOW TUBE
INTERACTIVE TUBE

PACKAGE CONTENTS



1. x1 Snow Tube Base
2. x1 Snow Tube
3. x1 Power Cable & Adaptor
4. x1 Remote
5. x4 Washers
6. x4 Wing Nuts

SNOW TUBE
INTERACTIVE TUBE

INSTALLATION

ASSEMBLY



1. To begin, you will need to remove the white plastic cover from the Snow Tube base. Taking care, firmly pull the cover up and lift away.

2. Locate the 4 holes on the bottom of the Snow Tube with the 4 studs on the Snow Tube base unit.

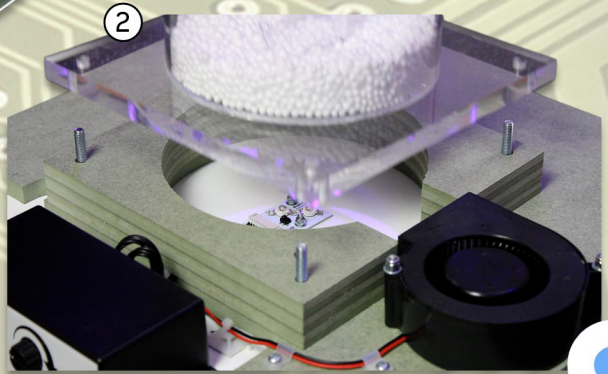

3. Place a washer, followed by a wing nut, onto each stud and tighten down.

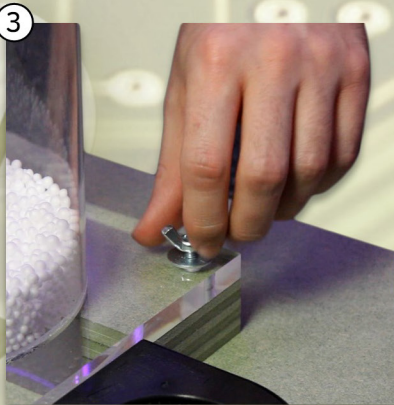

SNOW TUBE
INTERACTIVE TUBE

INSTALLATION



4. The Snow Tube base cover can now be replaced. Lower the cover over the Snow Tube and locate back in place on the base.



5. The power supply can now be plugged into the 12VDC socket. When the unit is powered on, the fan will activate to full speed for 5 seconds. This is to dislodge any of the snow particles that may have become stuck. Once the fan has finished this startup sequence, the dial can be used to set the desired fan speed.

SNOW TUBE
INTERACTIVE TUBE

OPERATION

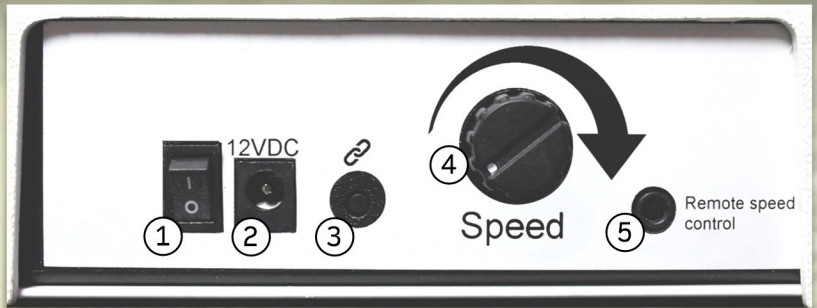

1. On/Off Button

When the Snow Tube is plugged into power, use this button to turn the product on/off.

2. Power Input

Use this to connect the power adapter cable. Use only the power supply included.

3. Pairing Button

This button is used to change the pairing channel of the product, if you would like it to only interact with specific devices. Hold this button for 5 seconds to enter pairing mode. The tube LED will flash continuously when in this mode. A compatible remote (not included) can now be used to set the pairing channel.

For more information, please contact your distributor.

4. Speed Dial

Use this dial to increase and decrease the fan speed. This will change the movement speed of the snow particles.

5. Remote Speed Control

This port is used to connect an auxiliary speed controller (not included).

SNOW TUBE
INTERACTIVE TUBE

TROUBLESHOOTING & CARE

TROUBLESHOOTING

The **Snow Tube** is designed to be low maintenance.

If problems occur:

- Power the unit off, unplug from mains socket and check that power cable is correctly inserted into the power input (see page 6).
- Turn off unit, unplug from mains socket and leave for 1 minute to perform a reset. After this time, plug the Snow Tube back into power and turn back on.
- The product must have sufficient air flow through the tube to allow the snow particles to move around. Ensure that the vent on top of the tube is not blocked and is letting the air flow out.

CLEANING

If cleaning the product becomes necessary, use only a soft damp cloth.

Do **NOT** use harsh chemicals or abrasives.

ELECTRICAL SPECIFICATION

POWER SUPPLY

INPUT: 100-240V 50/60Hz, 1.5A

OUTPUT: 12V 5A

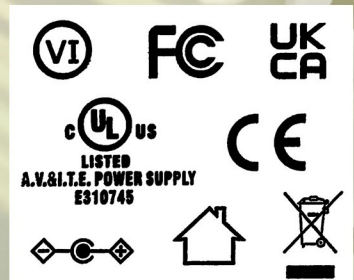

Power supply approvals

SNOW TUBE

INTERACTIVE TUBE



SNOW TUBE

INTERACTIVE TUBE